



Chester Vertical Machining Centre VL5



- The best choice for commencing CNC machining training
- Tool room workshop
- Metal parts machining
- Model making
- R&D
- Cast iron is tempered for stress relief to ensure structural stability without deformation



| Technical Specifications | | VL5 |
|------------------------------------|---|-----|
| Table | | |
| Table size | 650 x 300mm | |
| T-slot (width x number x distance) | 14 x 3 x 100mm | |
| Max. load | 200kgs | |
| Travel | | |
| X / Y / Z Travel | 500 / 300 / 400mm | |
| Spindle nose to table | 120 - 520mm | |
| Spindle centre to column | 340mm | |
| Spindle | | |
| Spindle taper | BT40 | |
| Spindle servo motor | 4.8 / 19 Siemens 5.5 / 7.5 Fanuc kW | |
| Spindle speed | 10.000 min ⁻¹ | |
| Feed | | |
| Rapid speed | X/Y: 24, Z: 16 m/min | |
| Cutting speed | 1-10.000 mm/min | |
| Tool changer | | |
| Number of tools | 12 pcs | |
| Max. tool length | 300mm | |
| Max. tool diameter | 90 / 125mm | |
| Max. tool weight | 8kgs | |
| Accuracy | | |
| VDI 3441 (Full travel) | Positioning accuracy 0.010 / Full Travel Positioning repeatability 0.008mm / Full Travel | |
| Dimensions & weight | | |
| Dimensions | 1660 x 2000 x 2500mm | |
| Weight | 1800kgs | |

Standard configuration

- ✓ Fully enclosed splash guard
- ✓ Belt drive spindle 10000 rpm
- ✓ 12 position umbrella tool changer
- ✓ Heat exchanger for electrical cabinet
- ✓ Rigid tapping
- ✓ Ethernet, CF card and USB interface
- ✓ Automatic lubrication system
- ✓ Coolant system
- ✓ LED working lamp
- ✓ End of program light
- ✓ Electronic handwheel (MPG)
- ✓ Tool box
- ✓ Leveling bolts and blocks
- ✓ Coolant gun
- ✓ Air gun
- ✓ Chip flushing system
- ✓ User Manual

Optional configuration

- Spindle cooling system
- Workpiece probe
- Tool probe
- Rotary table
- Oil skimmer



12 station umbrella tool changer

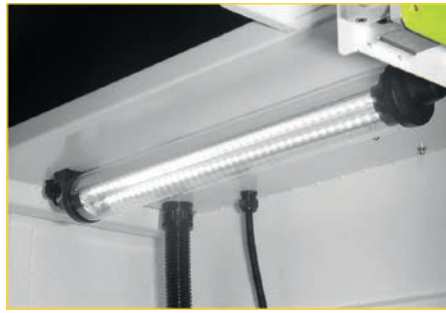

LED Internal lamp



Chip flushing system



4th axis (optional)



Tool probe (optional)



Chip collector & Coolant tank

Work table

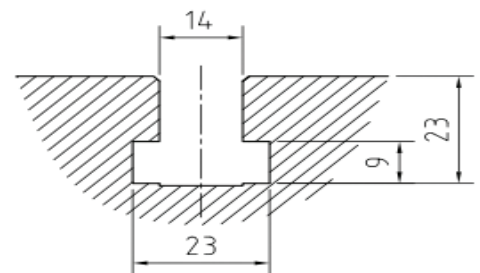
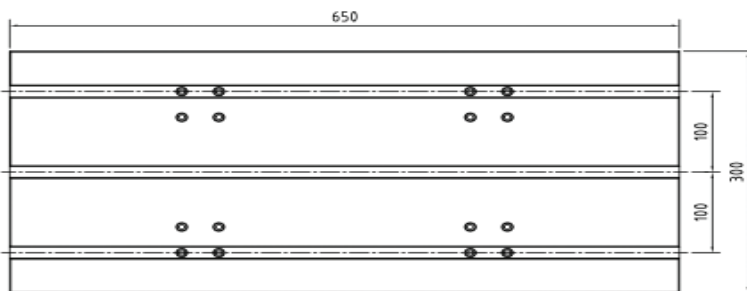

Dimensions

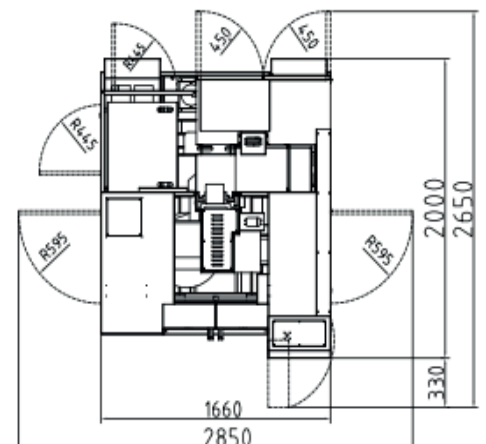
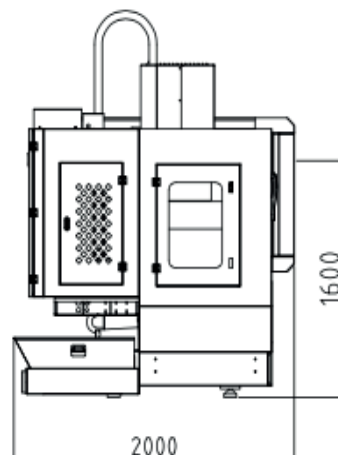
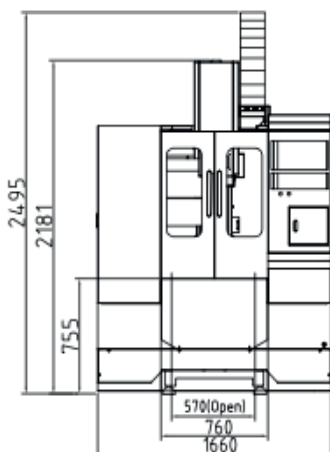



Chester Vertical Machining Centre • VL6



- Providing optimal performance. Ideal for mass production and machining metal parts.

| Technical Specification | VL6 |
|------------------------------------|---|
| Table | |
| Table size | 750 x 400mm |
| T-slot (width x number x distance) | 14 x 3 x 125mm |
| Max. load | 350kgs |
| Travel | |
| X/Y/Z Travel | 600 / 400 / 450mm |
| Spindle nose to table | 110 - 560mm |
| Spindle centre to column | 434mm |
| Spindle | |
| Spindle taper | BT40 |
| Spindle speed | 10.000 min ⁻¹ |
| Spindle servo motor | 4.8/19 kW Siemens 3.7 / 13 kW Fanuc |
| Feed | |
| Rapid feed X/Y/Z | 48 m/min |
| Cutting speed | 1-12.000 mm/min |
| Tool changer | |
| Number of tools | 24 pcs |
| Max. tool length | 220mm |
| Max. tool diameter | 78 (125)mm |
| Max. tool weight | 8kgs |
| Accuracy | |
| VDI 3441 (Full travel) | Positioning accuracy 0.010 / Full Travel Positioning repeatability 0.006mm / Full Travel |
| Dimensions & Weight | |
| Dimensions | 1800 x 2530 x 2700mm |
| Weight | 3500kgs |

- Tool room workshop
- Metal parts machining
- Mould making, R&D
- Cast iron is tempered for stress relief to ensure structural stability without deformation
- C3 class ballscrews ensures the highest accuracy and durability
- Pre-tension on all axes minimizes thermal distortion

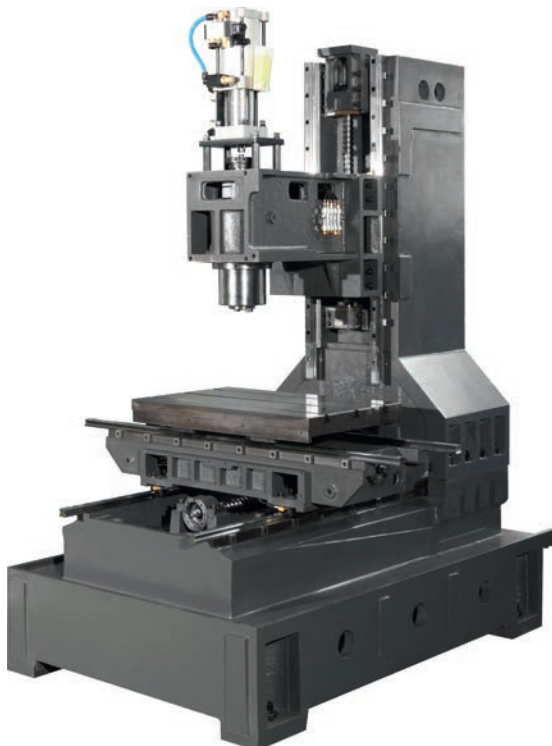

Standard configuration

- ✓ Siemens 828D/Fanuc Type 3 PLUS
- ✓ Fully Enclosed Splash Guard
- ✓ Shopmill (Siemens Only)
- ✓ Manual Guide I, AICCL and Data Server (Fanuc)
- ✓ Belt Drive Spindle 10000 rpm
- ✓ Spindle Oil Cooler
- ✓ Coolant Through Spindle
- ✓ 20 Pockets Arm Tool Changer
- ✓ Heat Exchanger for Electrical Cabinet
- ✓ Rigid Tapping
- ✓ Ethernet CF Card and Usb Interface
- ✓ Automatic Lubrication System
- ✓ Coolant System
- ✓ Led Working Lamp
- ✓ End Of Program Light
- ✓ Electronic Handwheel (Mpg)
- ✓ Tool Box
- ✓ Leveling Bolts and Blocks
- ✓ Coolant Gun
- ✓ Air Gun
- ✓ Chip Flushing System
- ✓ User Manual

Optional configuration:

- Spindle Speed 12000 rpm, Direct Drive
- 4th Axis
- Workpiece Probe
- Tool Probe
- Oil Skimmer

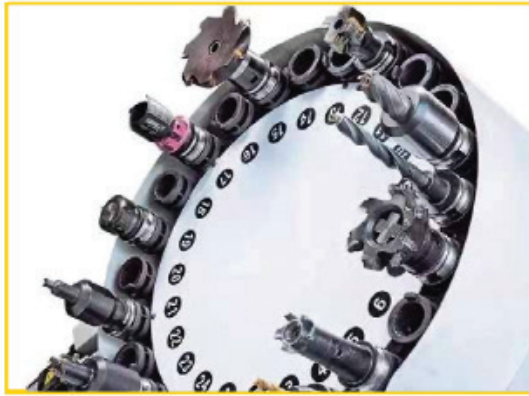

20 pocket arm tool changer

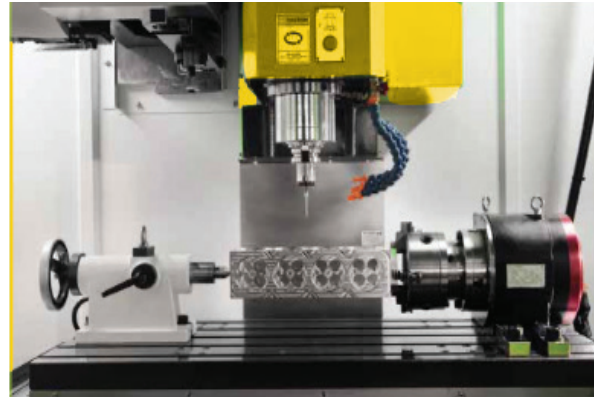

4th axis (optional)

Work table

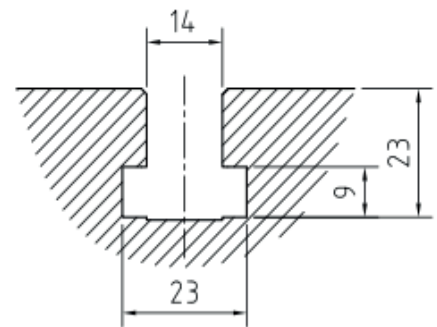
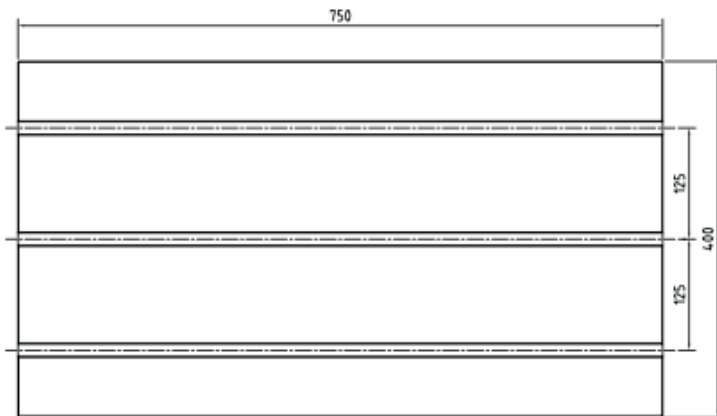

Dimensions

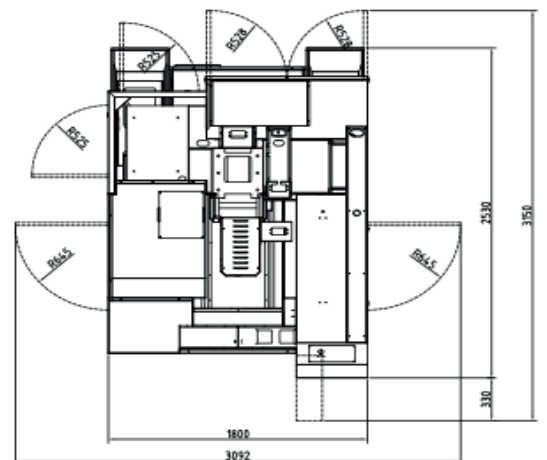
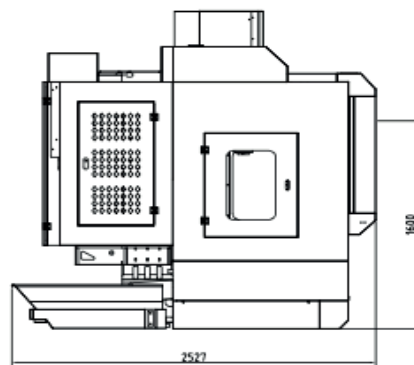
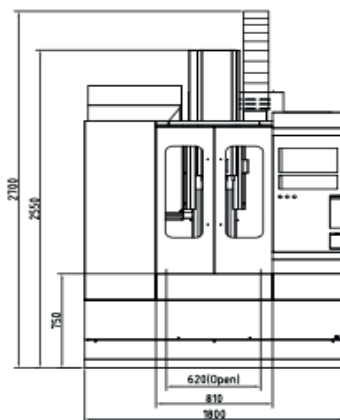



Chester Vertical Machining Centre • VL7B



| Technical Specifications | VL7B |
|--|--|
| Table | |
| Table size | 900 x 420mm |
| T-slot (width x number x distance) | 14 x 3 x 125mm |
| Max. load | 500kgs |
| Travel | |
| X/Y/Z Travel | 760 / 450 / 520mm |
| Spindle nose to table | 100 - 620mm |
| Spindle centre to column | 517mm |
| Spindle | |
| Spindle taper | BT40 |
| Spindle speed | 10.000 min ⁻¹ |
| Spindle servo motor | 7/15kW, 52/95Nm Siemens 3.7 / 13 kW Fanuc |
| Feed | |
| Rapid feed X/Y/Z | 30m/min |
| Cutting speed | 1-12.000 mm/min |
| Tool changer | |
| Number of tools | 24 pcs |
| Max. tool length | 300mm |
| Max. tool diameter | 78 (125) |
| Max. tool weight | 8kgs |
| Accuracy (VDI 3441) | |
| Positioning accuracy (without linear encoder) | 0.008mm / Full Travel |
| Positioning repeatability (without linear encoder) | 0.006mm / Full Travel |
| Dimensions & Weight | |
| Dimensions | 3250 x 2710 x 2900mm |
| Weight | 4500kgs |



Standard configuration:

- ✓ Siemens 828D/Fanuc Type 3 PLUS
- ✓ Fully Enclosed Splash Guard
- ✓ Shopmill (Siemens) Manual Guide I, AICCI and Data Server (Fanuc)
- ✓ Belt Drive Spindle 10000 rpm
- ✓ Spindle Oil Cooler
- ✓ Coolant Through Spindle
- ✓ 24 Pockets Arm Tool Changer
- ✓ Air Conditioning for Electrical Cabinet
- ✓ Rigid Tapping
- ✓ Ethernet CF Card and Usb Interface
- ✓ Automatic Lubrication System
- ✓ Coolant System
- ✓ Led Working Lamp
- ✓ End Of Program Light
- ✓ Electronic Handwheel (Mpg)
- ✓ Tool Box
- ✓ Leveling Bolts and Blocks
- ✓ Coolant Gun
- ✓ Air Gun
- ✓ Screw Type Chip Conveyor
- ✓ Chip Flushing System
- ✓ User Manual

Optional configuration:

- Spindle Speed 12000 rpm, Direct Drive
- 4th Axis
- Workpiece Probe
- Tool Probe
- Oil Skimmer



Working table

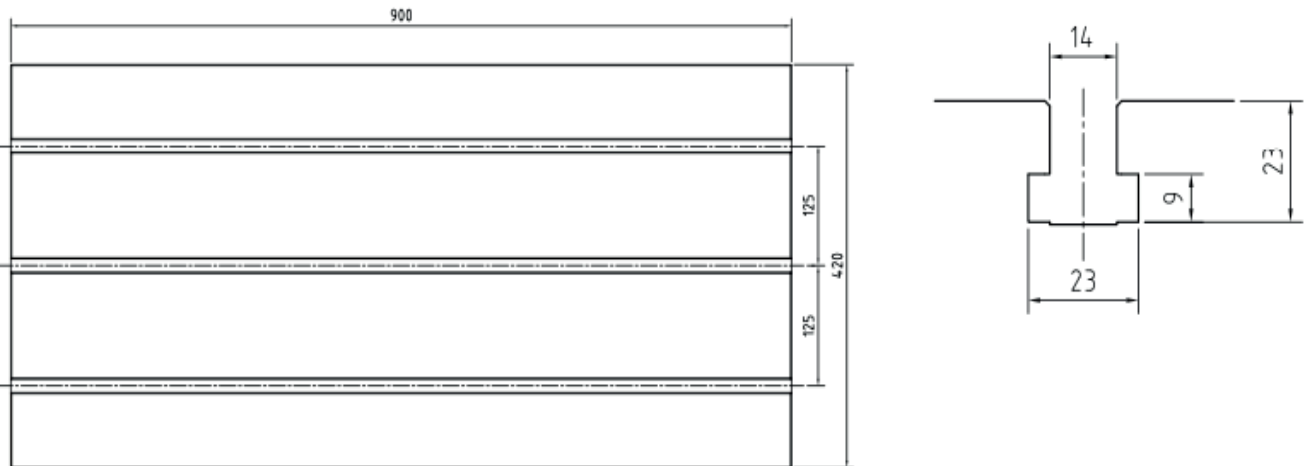

Dimensions

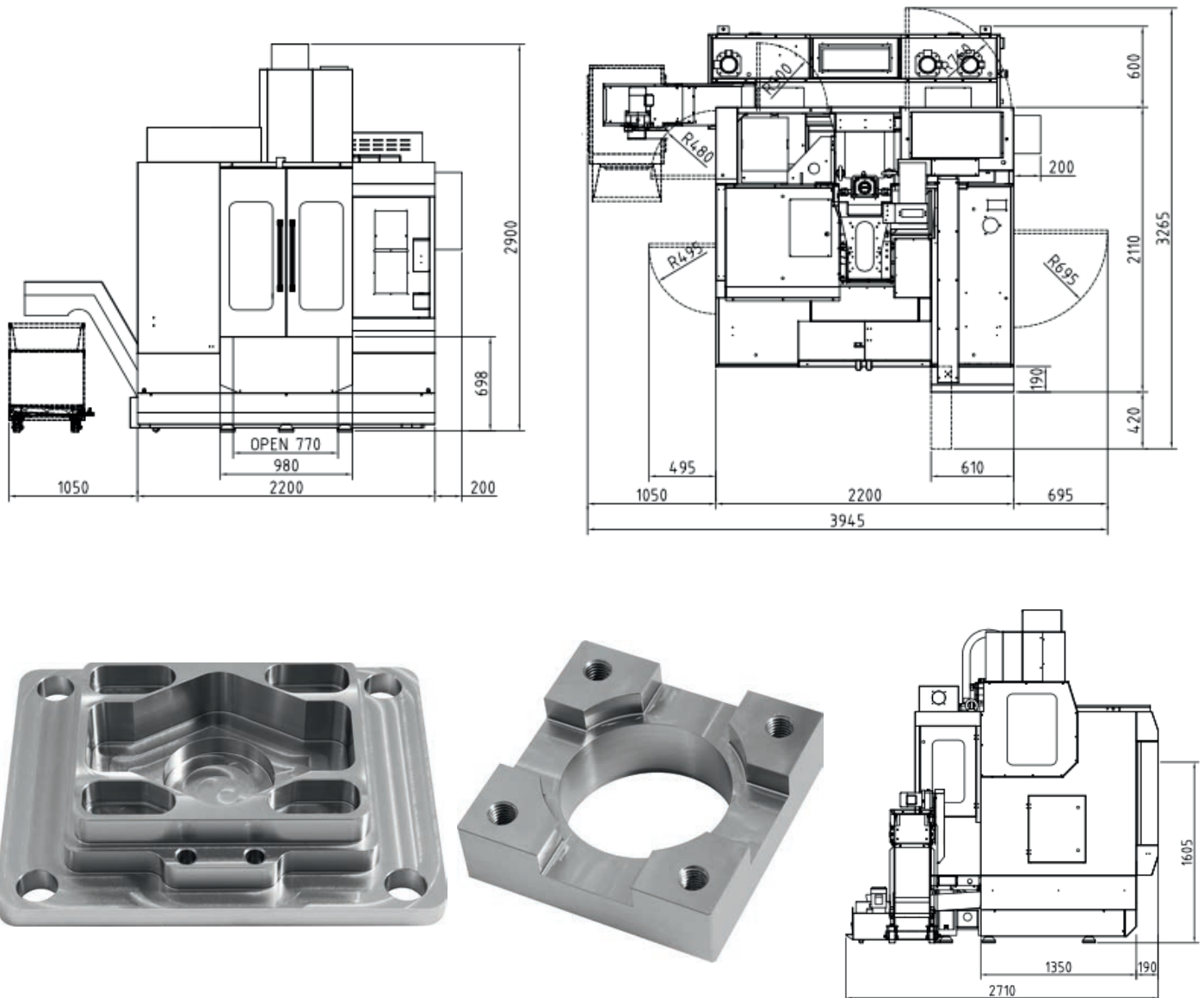



Chester Vertical Machining Centre • VL7



- High Performance
- High Rigidity
- Suitable for Mould Making

| Technical Specifications | VL7 |
|--|--------------------------------------|
| Table | |
| Table size | 900 x 420mm |
| T-slot (width x number x distance) | 14 x 3 x 125mm |
| Max. load | 500kgs |
| Travel | |
| X/Y/Z Travel | 760 / 450 / 520mm |
| Spindle nose to table | 100 - 620mm |
| Spindle centre to column | 517mm |
| Spindle | |
| Spindle taper | BT40 |
| Spindle speed | 10.000 min ⁻¹ |
| Spindle servo motor | 9 / 22 kW Siemens 7.5/15 kW Fanuc |
| Feed | |
| Rapid feed X/Y/Z | 48 m/min |
| Cutting speed | 1-12.000 mm/min |
| Tool changer | |
| Number of tools | 24 pcs |
| Max. tool length | 300mm |
| Max. tool diameter | 78 (125) |
| Max. tool weight | 8kgs |
| Accuracy (VDI 3441) | |
| Positioning accuracy (without linear encoder) | 0.008mm / Full Travel |
| Positioning repeatability (without linear encoder) | 0.006mm / Full Travel |
| Positioning accuracy (with linear encoder) | 0.006mm / Full Travel |
| Positioning repeatability (with linear encoder) | 0.004mm / Full Travel |
| Dimensions & Weight | |
| Dimensions | 3450 x 2710 x 2900mm |
| Weight | 4500kgs |



Standard configuration:

- ✓ Siemens 828D/Fanuc Type 3 PLUS
- ✓ Fully Enclosed Splash Guard
- ✓ Shopmill (Siemens)
- ✓ Manual Guide I, AICCI and Data Server (Fanuc)
- ✓ Belt Drive Spindle 10000 rpm
- ✓ Spindle Oil Cooler
- ✓ Coolant Through Spindle
- ✓ 24 Pockets Arm Tool Changer
- ✓ Air Conditioning for Electrical Cabinet
- ✓ Rigid Tapping
- ✓ Ethernet CF Card and Usb Interface
- ✓ Automatic Lubrication System
- ✓ Coolant System
- ✓ Led Working Lamp
- ✓ End Of Program Light
- ✓ Electronic Handwheel (Mpg)
- ✓ Tool Box
- ✓ Leveling Bolts and Blocks
- ✓ Coolant Gun
- ✓ Air Gun
- ✓ Chain Type Chip Conveyor
- ✓ Chip Flushing System
- ✓ User Manual

Optional configuration:

- Spindle Speed 12000 rpm, Direct Drive
- 4th or 4/5th Axis
- Workpiece Probe
- Tool Probe
- Oil Skimmer



Working table

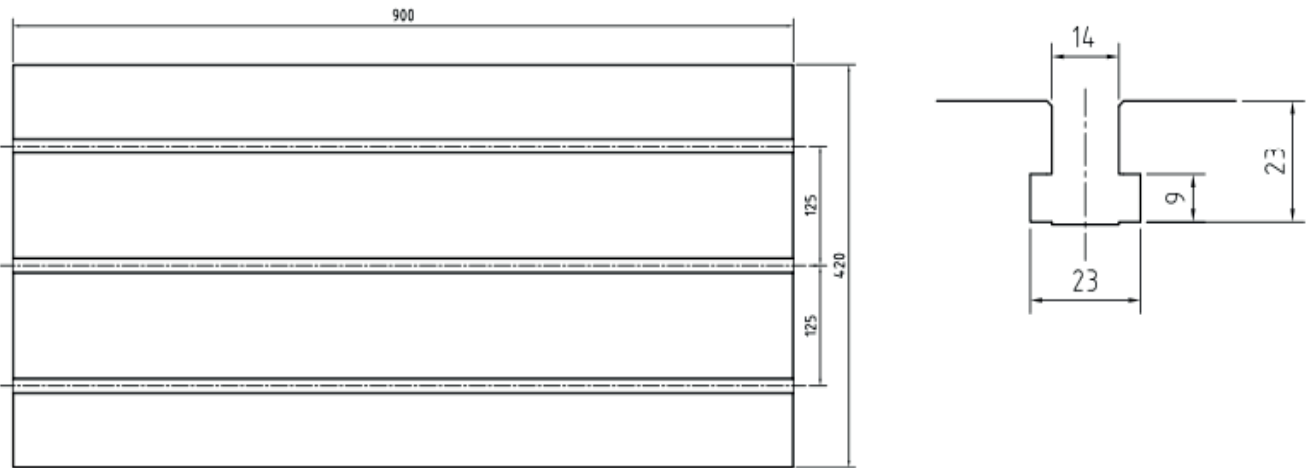

Dimensions

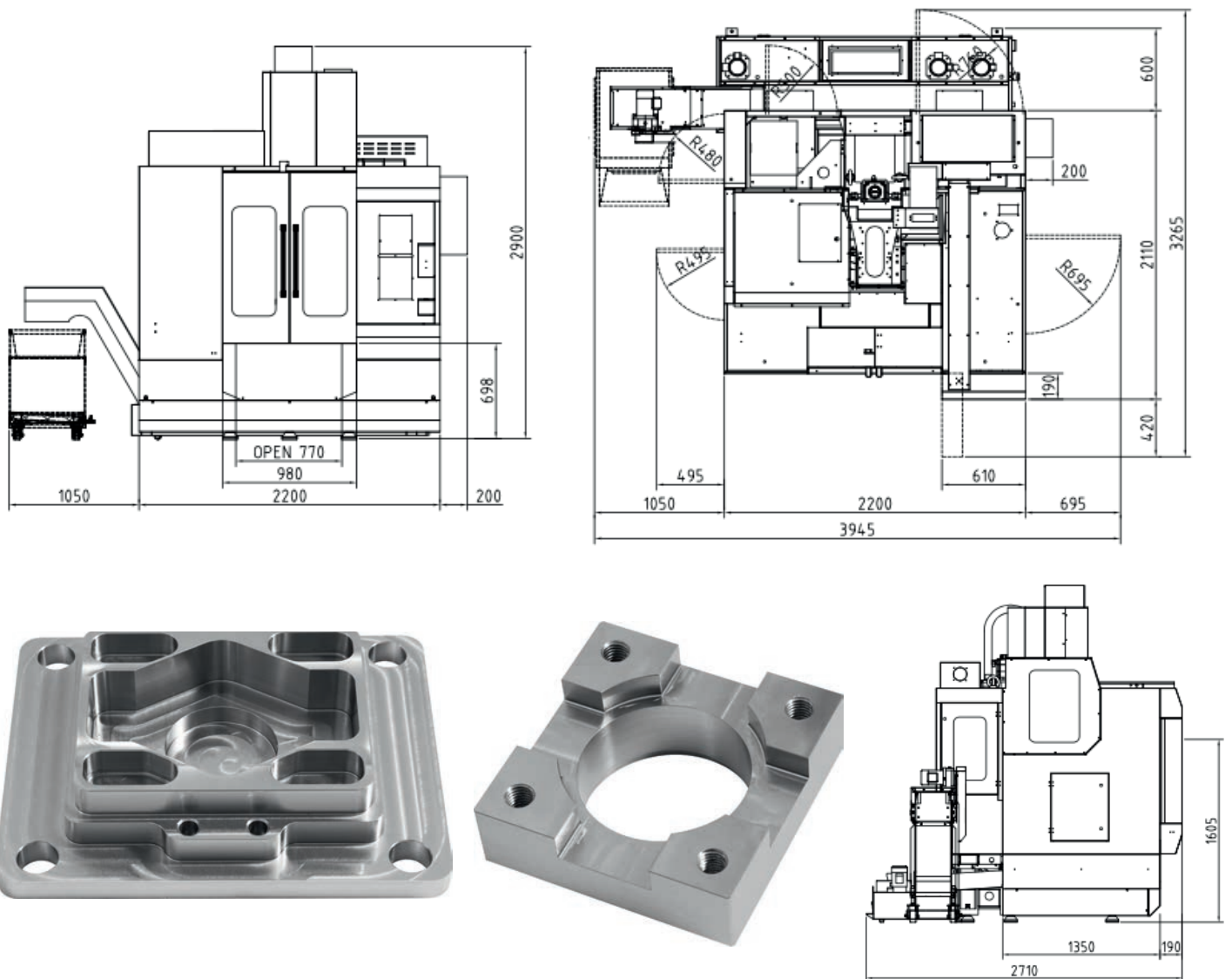



Chester Vertical Machining Centre • VL9



- High Performance
- High Rigidity
- Suitable for Mould Making
- Cast iron is tempered for stress relief to ensure structural stability without deformation
- C3 class ballscrews ensures the highest accuracy and durability
- Pre-tension on all axis minimizes thermal distortion

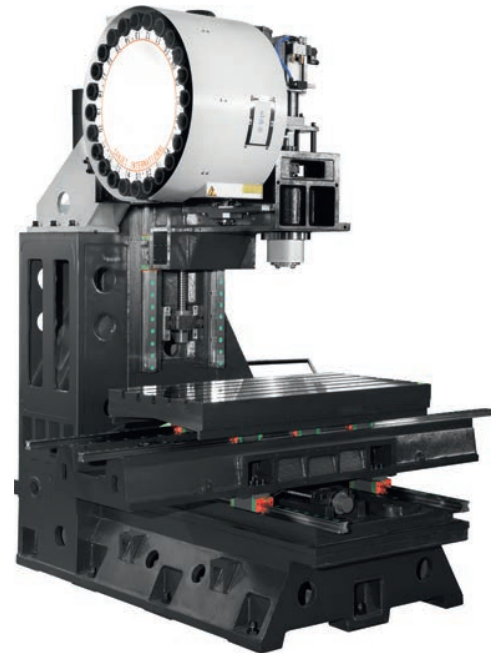

| Technical Specifications | VL9 |
|--|---|
| Table | |
| Table size | 1060 × 600mm |
| T-slots (width x number x distance) | 18 x 5 x 100mm |
| Max. load | 800kgs |
| Travel | |
| X/Y/Z Travel | 900 / 600 / 600mm |
| Spindle nose to table | 150 - 750mm |
| Spindle centre to column | 652mm |
| Spindle | |
| Spindle taper | BT40 |
| Spindle servo motor | 9 / 22 kW Siemens 11 / 18.5 kW Fanuc |
| Spindle speed | 10.000 min ⁻¹ |
| Feed | |
| Rapid feed X/Y/Z | 36 m/min |
| Cutting speed | 1-12.000 mm/min |
| Tool changer | |
| Number of tools | 24 pcs |
| Max. tool length | 300mm |
| Max. tool diameter | 78 (125)mm |
| Max. weight | 8kgs |
| Accuracy (VDI 3441) | |
| Positioning accuracy (without linear encoder) | 0.008mm / Full Travel |
| Positioning repeatability (without linear encoder) | 0.006mm / Full Travel |
| Positioning accuracy (with linear encoder) | 0.006mm / Full Travel |
| Positioning repeatability (with linear encoder) | 0.004mm / Full Travel |
| Dimensions & weight | |
| Dimensions | 3850 x 2336 x 3000mm |
| Weight | 6300kgs |

Standard configuration

- ✓ Siemens 828D/Fanuc Type 3 PLUS
- ✓ Fully Enclosed Splash Guard
- ✓ Shopmill (Siemens)
- ✓ Manual Guide I, AICCL and Data Server (Fanuc)
- ✓ Belt Drive Spindle 10000 rpm
- ✓ Spindle Oil Cooler
- ✓ Coolant Through Spindle
- ✓ 24 Pockets Arm Tool Changer
- ✓ Air Conditioning for Electrical Cabinet
- ✓ Rigid Tapping
- ✓ Ethernet CF Card and Usb Interface
- ✓ Automatic Lubrication System
- ✓ Coolant System
- ✓ Led Working Lamp
- ✓ End Of Program Light
- ✓ Electronic Handwheel (Mpg)
- ✓ Tool Box
- ✓ Leveling Bolts and Blocks
- ✓ Coolant Gun
- ✓ Air Gun
- ✓ Chain Type Chip Conveyor
- ✓ Chip Flushing System
- ✓ User Manual

Optional configuration

- Spindle Speed 12000 rpm, Direct Drive
- Spindle Speed 15000 rpm, Direct Drive
- 4th or 4.5th Axis
- Workpiece Probe
- Tool Probe
- Oil Skimmer



Work table

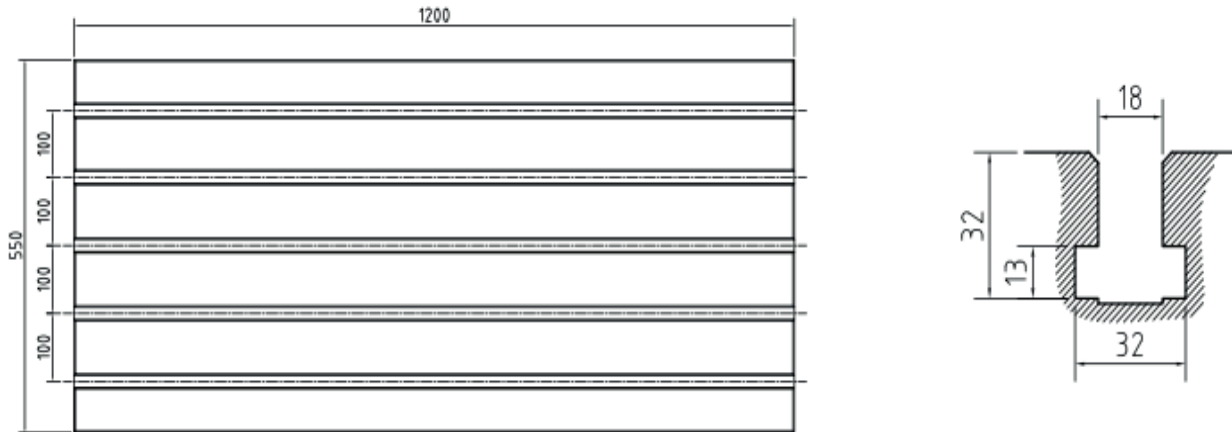

Dimensions

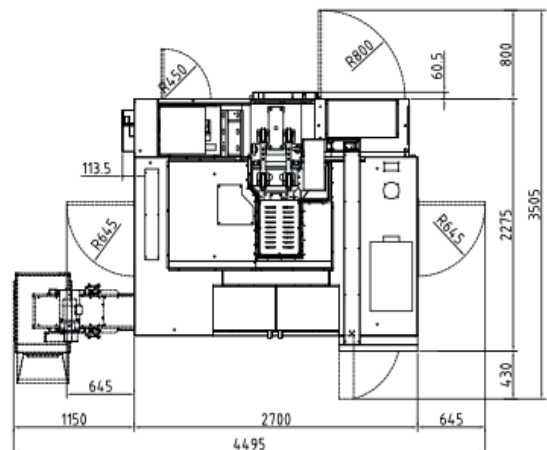
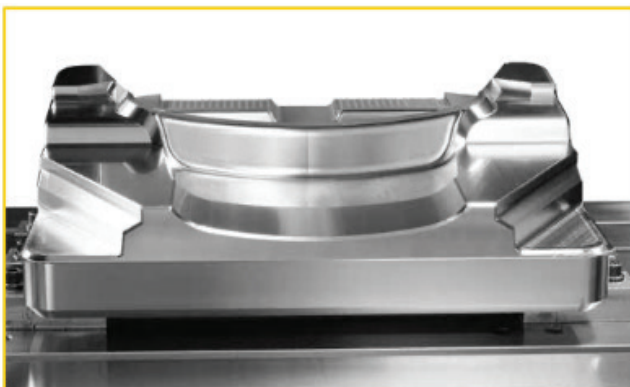
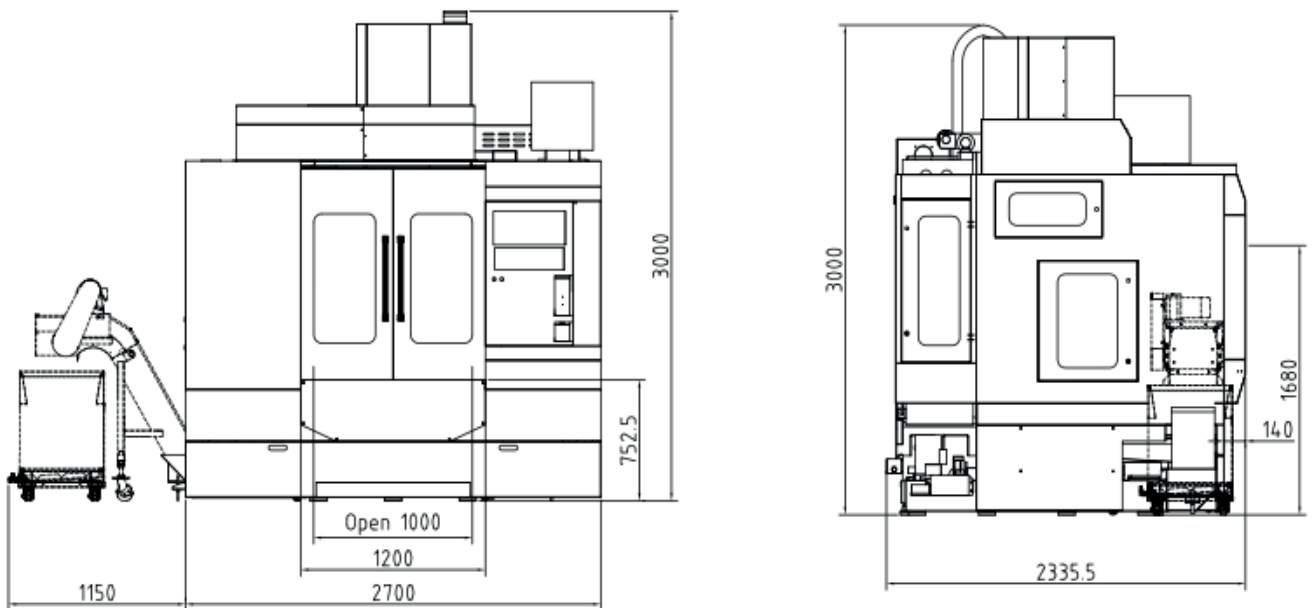



Chester Vertical Machining Centre • VL10



- Ideal for mass production and machining metal parts
- Cast iron is tempered for stress relief to ensure structural stability without deformation
- Pre-tension on all axes minimizes thermal distortion
- C3 class ballscrews ensures the highest accuracy and durability

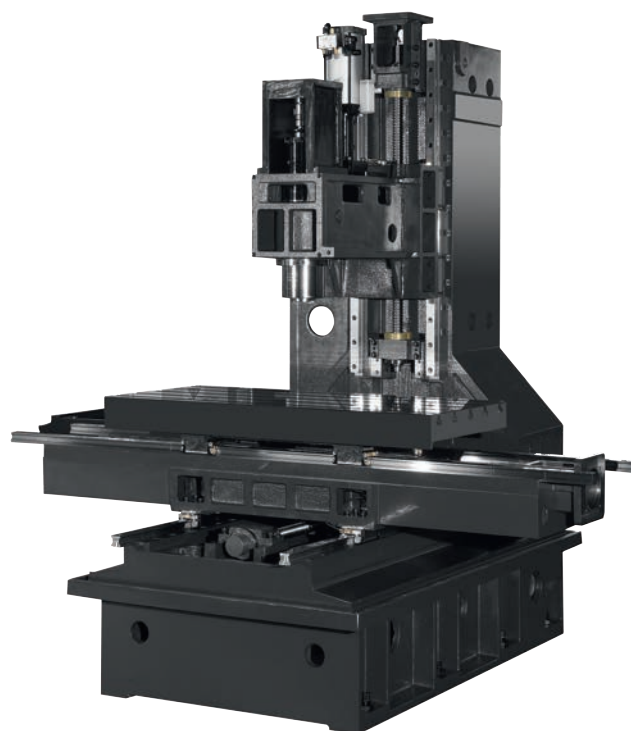

| Technical Specifications | | VL10 |
|--|---|------|
| Table | | |
| Table size | 1100 x 500mm | |
| T-slot (width x number x distance) | 18 x 5 x 100mm | |
| Max. load | 600kgs | |
| Travel | | |
| X/Y/Z Travel | 1020 / 530 / 560mm | |
| Spindle nose to table | 115 - 675mm | |
| Spindle centre to column | 566mm | |
| Spindle | | |
| Spindle taper | BT40 | |
| Spindle speed | 10.000 min ⁻¹ | |
| Spindle servo motor | 9 / 22 kW Siemens 7.5 / 15 kW Fanuc | |
| Tool changer | | |
| Number of tools | 24 pcs | |
| Max. tool diameter (without adjacent tool) | 78 (125)mm | |
| Max. tool length | 300mm | |
| Max. tool weight | 8kgs | |
| Feed | | |
| Rapid feed X/Y/Z | 48 (opt. 30) m/min | |
| Cutting speed | 1-12.000 mm/min | |
| Accuracy | | |
| VDI 3441 (Full travel) | Positioning accuracy 0.010 / Full Travel Positioning repeatability 0.006mm / Full Travel | |
| Dimensions & weight | | |
| Dimensions | 3870 x 2175 x 2850mm | |
| Weight | 5000kgs | |

Standard configuration

- ✓ Siemens 828D/Fanuc Type 3 PLUS
- ✓ Fully Enclosed Splash Guard
- ✓ Shopmill (Siemens)
- ✓ Manual Guide I, AICCI and Data Server (Fanuc)
- ✓ Belt Drive Spindle 10000 rpm
- ✓ Spindle Oil Cooler
- ✓ Coolant Through Spindle
- ✓ 24 Pockets Arm Tool Changer
- ✓ Air Conditioning for Electrical Cabinet
- ✓ Rigid Tapping
- ✓ Ethernet CF Card and Usb Interface
- ✓ Automatic Lubrication System)
- ✓ Coolant System
- ✓ Led Working Lamp
- ✓ End Of Program Light
- ✓ Electronic Handwheel (Mpg)
- ✓ Tool Box
- ✓ Leveling Bolts and Blocks
- ✓ Coolant Gun
- ✓ Air Gun
- ✓ Chain Type Chip Conveyor
- ✓ Chip Flushing System
- ✓ User Manual

Optional configuration

- Spindle Speed 12000 rpm, Direct Drive
- 4th or 4/5th Axis
- Workpiece Probe
- Tool Probe
- Oil Skimmer



Work table

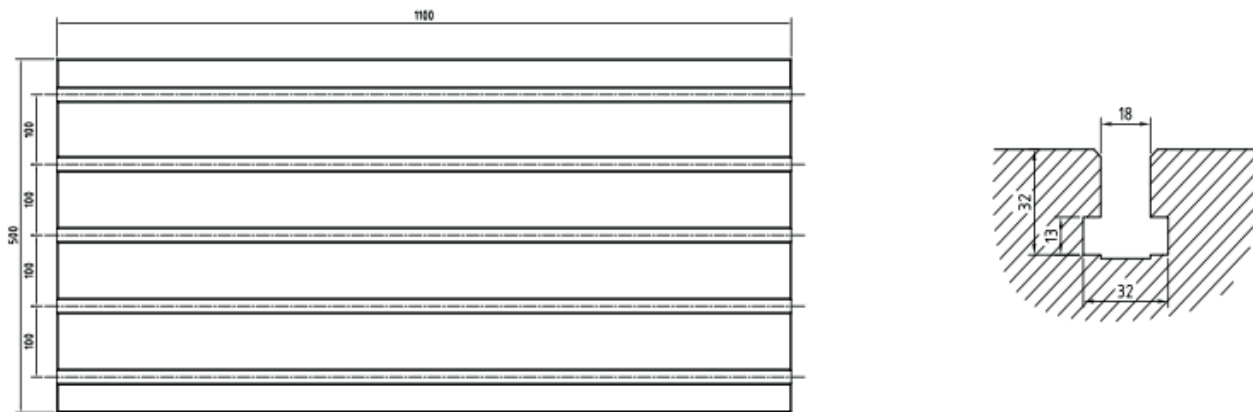

Dimensions

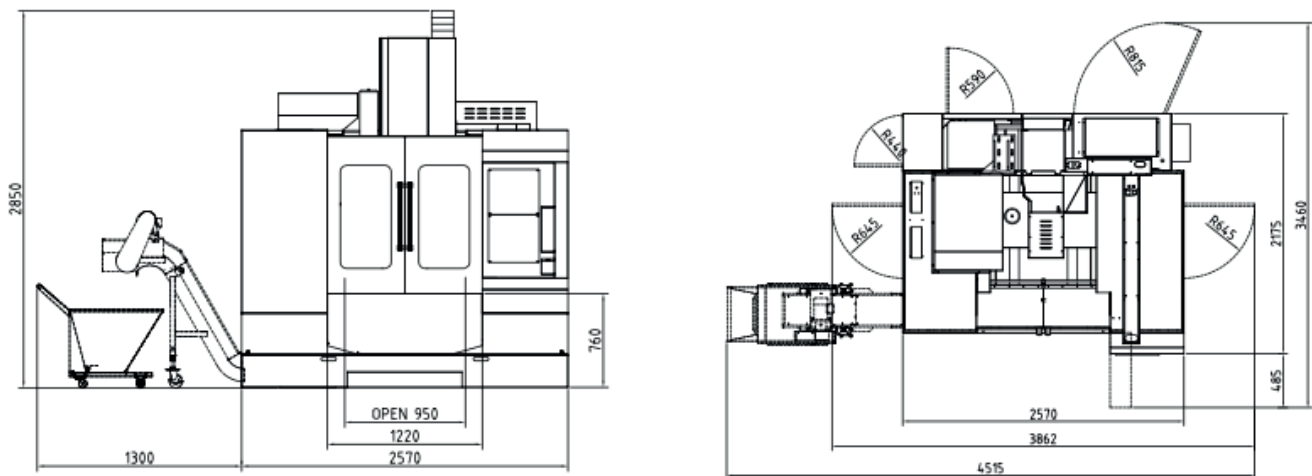

4th axis, different sizes

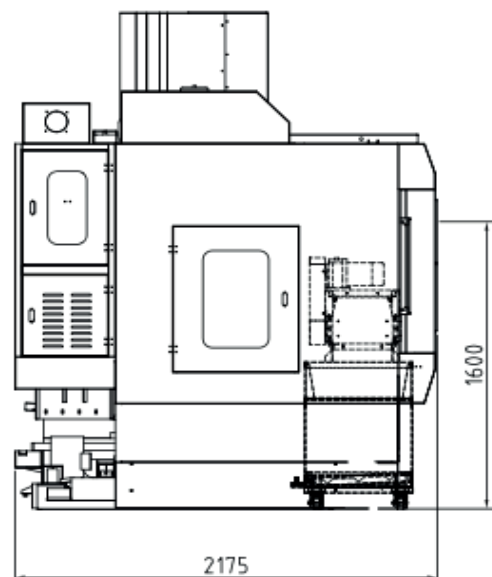



Chester Vertical Machining Centre • VL11



- High Performance
- High Rigidity
- Suitable for Mould Making
- Cast iron is tempered for stress relief to ensure structural stability without deformation
- C3 class ballscrews ensures the highest accuracy and durability
- Pre-tension on all axis minimizes thermal distortion

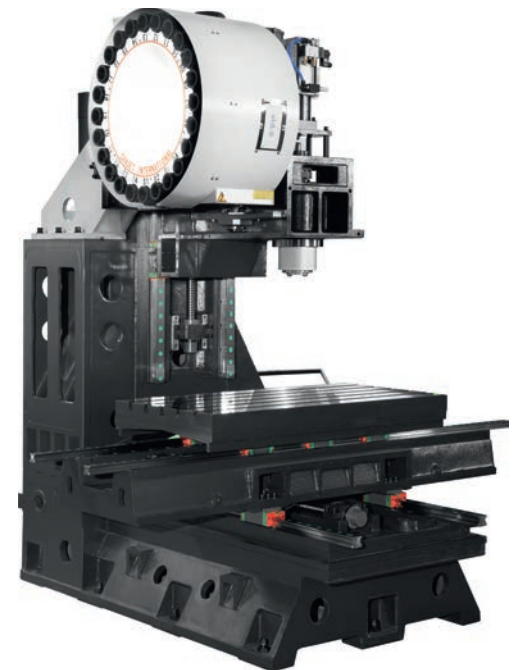

| Technical Specifications | VL11 |
|--|---|
| Table | |
| Table size | 1200 x 600mm |
| T-slots (width x number x distance) | 18 x 5 x 100mm |
| Max. load | 1000kgs |
| Travel | |
| X/Y/Z Travel | 1100 / 600 / 600mm |
| Spindle nose to table | 150 - 750mm |
| Spindle centre to column | 652mm |
| Spindle | |
| Spindle taper | BT40 |
| Spindle servo motor | 9 / 22 kW Siemens 11 / 18.5 kW Fanuc |
| Spindle speed | 10.000 min ⁻¹ |
| Feed | |
| Rapid feed X/Y/Z | 36 m/min |
| Cutting speed | 1-12.000 mm/min |
| Tool changer | |
| Number of tools | 24 pcs |
| Max. tool length | 300mm |
| Max. tool diameter | 78 (125)mm |
| Max. weight | 8kgs |
| Accuracy (VDI 3441) | |
| Positioning accuracy (without linear encoder) | 0.008mm / Full Travel |
| Positioning repeatability (without linear encoder) | 0.006mm / Full Travel |
| Positioning accuracy (with linear encoder) | 0.006mm / Full Travel |
| Positioning repeatability (with linear encoder) | 0.004mm / Full Travel |
| Dimensions & weight | |
| Dimensions | 3850 x 2336 x 3000mm |
| Weight | 6500kgs |

Standard configuration

- ✓ Siemens 828D/Fanuc Type 3 PLUS
- ✓ Fully Enclosed Splash Guard
- ✓ Shopmill (Siemens)
- ✓ Manual Guide I, AIC2II and Data Server (Fanuc)
- ✓ Belt Drive Spindle 10000 rpm
- ✓ Spindle Oil Cooler
- ✓ Coolant Through Spindle
- ✓ 24 Pockets Arm Tool Changer
- ✓ Air Conditioning for Electrical Cabinet
- ✓ Rigid Tapping
- ✓ Ethernet CF Card and Usb Interface
- ✓ Automatic Lubrication System
- ✓ Coolant System
- ✓ Led Working Lamp
- ✓ End Of Program Light
- ✓ Electronic Handwheel (Mpg)
- ✓ Tool Box
- ✓ Leveling Bolts and Blocks
- ✓ Coolant Gun
- ✓ Air Gun
- ✓ Chain Type Chip Conveyor
- ✓ Chip Flushing System
- ✓ User Manual

Optional configuration

- Spindle Speed 12000 rpm, Direct Drive
- Spindle Speed 15000 rpm, Direct Drive
- 4th or 4/5th Axis
- Workpiece Probe
- Tool Probe
- Oil Skimmer



Work table

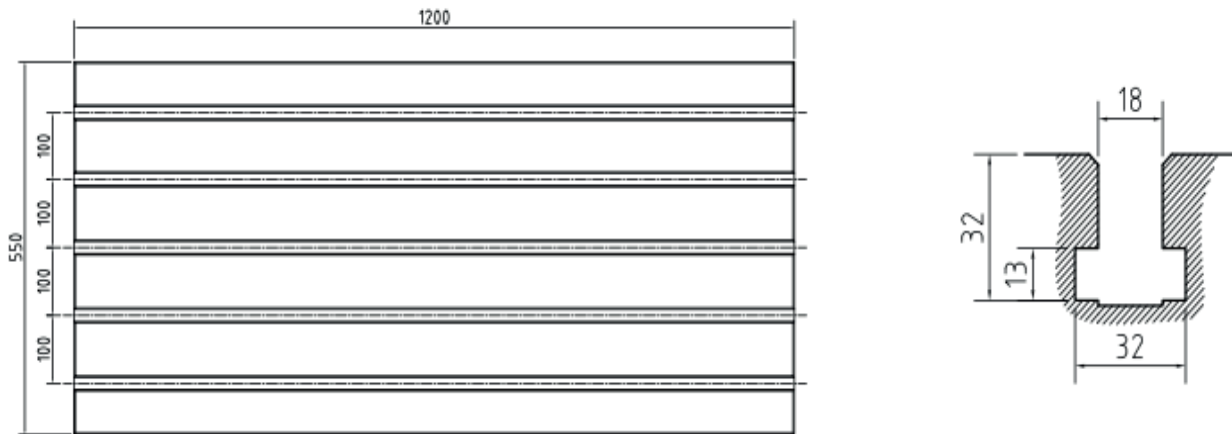

Dimensions

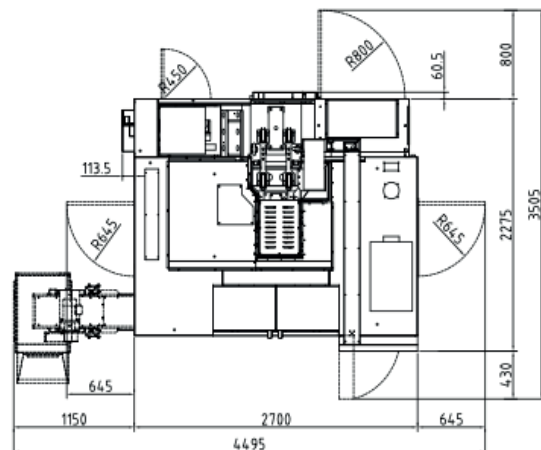
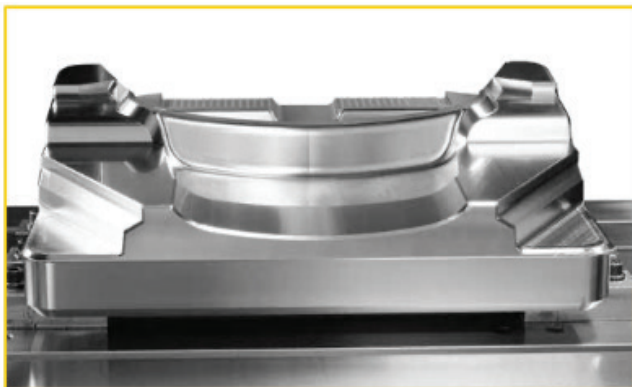
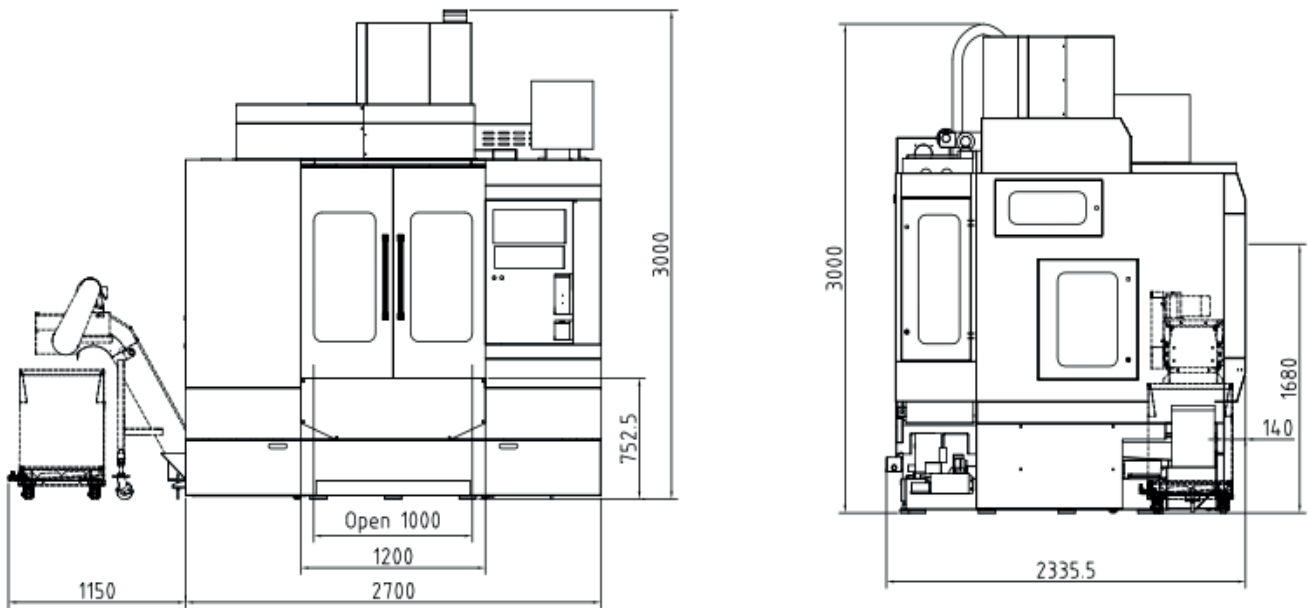



Chester Vertical Machining Centre • VL13 - VL15



- High Performance
- High Rigidity
- Suitable for Mould Making



- Cast iron is tempered for stress relief to ensure structural stability without deformation
- C3 class ballscrews ensures the highest accuracy and durability

| Technical Specifications | VL13 | VL15 |
|--|--|--------------------|
| Table | | |
| Table size | 1500 × 650mm | 1700 x 700mm |
| T-slots (width x number x distance) | 18 x 5 x 100mm | 18 x 6 x 100mm |
| Max. load | 1200kg | 1500kg |
| Travel | | |
| X/Y/Z Travel | 1300 / 650 / 600mm | 1500 / 760 / 700mm |
| Spindle nose to table | 150 - 750mm | 130 - 830mm |
| Spindle centre to column | 697mm | 802mm |
| Spindle | | |
| Spindle taper | BT40 | |
| Spindle speed | 10,000rpm | |
| Spindle motor power | 20 / 53 kW Siemens; 11 / 18.5 kW Fanuc | |
| Feed | | |
| Rapid feed X/Y/Z | 36 m/min | |
| Cutting speed | 1-12.000 mm/min | |
| Tool changer | | |
| Number of tools | 24 pcs | |
| Max. tool length | 300mm | |
| Max. tool diameter | 78/125mm | |
| Max. weight | 8kg | |
| Accuracy (VDI 3441) | | |
| Positioning accuracy (without linear encoder) | 0.010mm / Full Travel | |
| Positioning repeatability (without linear encoder) | 0.006mm / Full Travel | |
| Positioning accuracy (with linear encoder) | 0.008mm / Full Travel | |
| Positioning repeatability (with linear encoder) | 0.006mm / Full Travel | |
| Dimensions & weight | | |
| Dimensions | 4025 x 3693 x 3250mm | 5000x2432x-3100mm |
| Weight | 8000kgs | 10000kgs |

Standard configuration

- ✓ Siemens 828D/Fanuc Type 3 PLUS
- ✓ Fully Enclosed Splash Guard
- ✓ Shopmill (Siemens)
- ✓ Manual Guide I, AICII and Data Server (Fanuc)
- ✓ Belt Drive Spindle 10000 rpm
- ✓ Spindle Oil Cooler
- ✓ Coolant Through Spindle
- ✓ 24 Pockets Arm Tool Changer
- ✓ Air Conditioning for Electrical Cabinet
- ✓ Rigid Tapping
- ✓ Ethernet CF Card and Usb Interface
- ✓ Automatic Lubrication System
- ✓ Coolant System
- ✓ Led Working Lamp
- ✓ End Of Program Light
- ✓ Electronic Handwheel (Mpg)
- ✓ Tool Box
- ✓ Leveling Bolts and Blocks
- ✓ Coolant Gun
- ✓ Air Gun
- ✓ Chain Type Chip Conveyor
- ✓ User Manual

Optional configuration

- Spindle Speed 12000 rpm, Direct Drive
- Spindle Speed 15000 rpm, Direct Drive
- BT50 Spindle
- 4th or 4/5th Axis
- Workpiece Probe
- Tool Probe



Work table

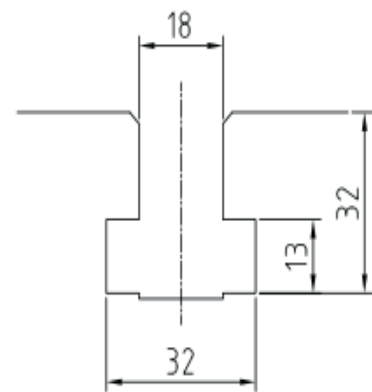
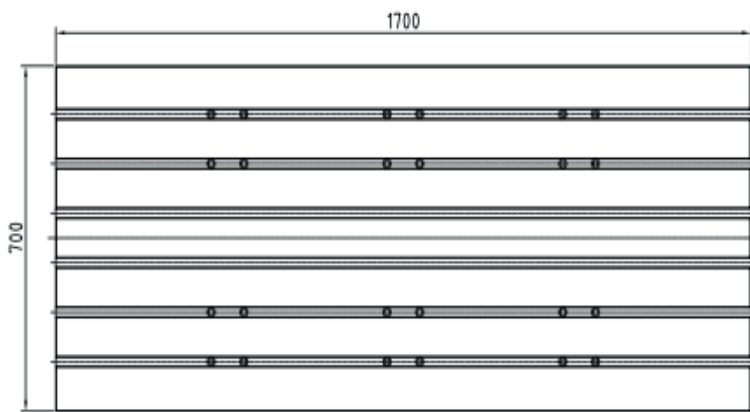

Dimensions

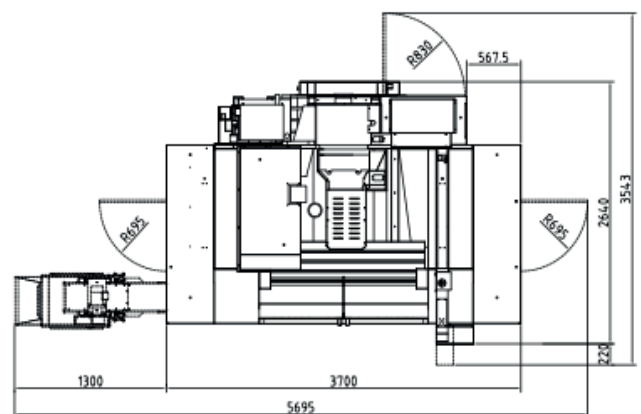
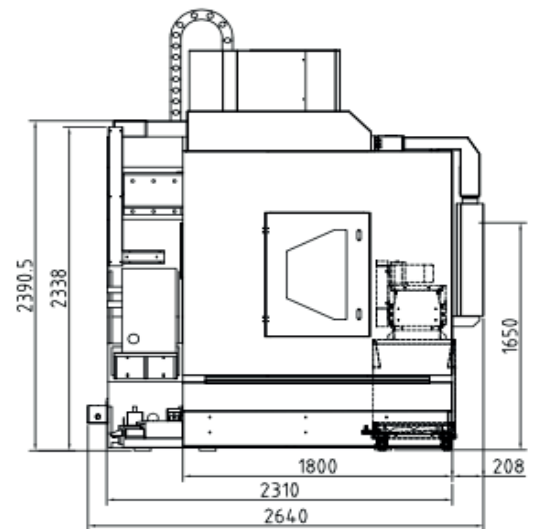
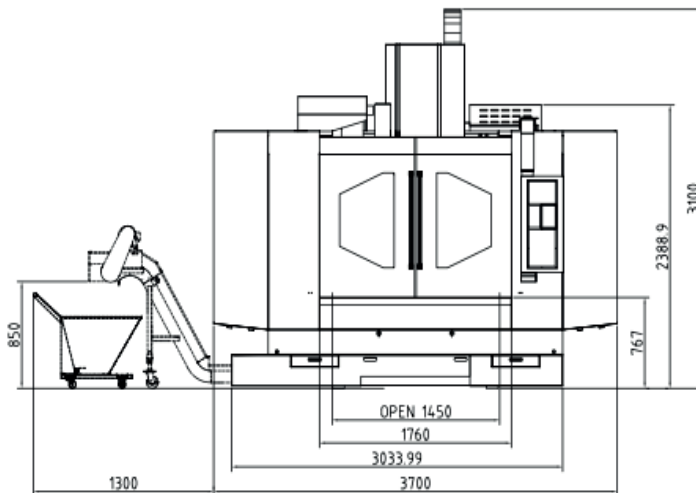

5th axis, different sizes



Chester Power Centre • VP18



- Ideal choice for heavy duty cutting with larger workpieces
- X and Y axis with roller type linear guideways and Z axis with box-way guideways
- 50 taper spindle with belt drive 6000 rpm as standard. Optional Gearbox spindle also available.

| Technical Specifications | | VP18 |
|--|--|------|
| Table | | |
| Table size | 2000 x 900mm | |
| T-slot (width x number x distance) | 18 x 7 x 120mm | |
| Max. load | 2000kgs | |
| Travel | | |
| X / Y / Z Travel | 1800 / 900 / 600mm | |
| Spindle nose to table | 110 - 710mm | |
| Spindle centre to column | 950mm | |
| Spindle | | |
| Spindle taper | BT50 | |
| Spindle servo motor | 22 / 60 kW Siemens 15 / 18.5 kW Fanuc | |
| Spindle speed | 6.000 min ⁻¹ | |
| Feed | | |
| Rapid speed X/Y/Z | 20/20/15 m/min | |
| Cutting speed | 1-12000 mm/min | |
| Tool changer | | |
| Number of tools | 24 pcs | |
| Max. tool length | 400mm | |
| Max. tool diameter | 125 / 245 (next release)mm | |
| Max. tool weight | 15kgs | |
| Accuracy (VDI 3441) | | |
| Positioning accuracy (without linear encoder) | 0.016mm / Full Travel | |
| Positioning repeatability (without linear encoder) | 0.010mm / Full Travel | |
| Positioning accuracy (with linear encoder) | 0.012mm / Full Travel | |
| Positioning repeatability (with linear encoder) | 0.008mm / Full Travel | |
| Dimensions & weight | | |
| Dimensions | 6060 x 3270 x 3650mm | |
| Weight | 17500kgs | |

Standard configuration

- ✓ Siemens 828D/Fanuc Type 3 PLUS
- ✓ Fully Enclosed Splash Guard
- ✓ Shopmill (Siemens)
- ✓ Manual Guide I, AICCI and Data Server (Fanuc)
- ✓ Belt Drive Spindle 10000 rpm
- ✓ Spindle Oil Cooler
- ✓ Coolant Through Spindle
- ✓ 24 Pockets Arm Tool Changer
- ✓ Air Conditioning for Electrical Cabinet
- ✓ Rigid Tapping
- ✓ Ethernet CF Card and Usb Interface
- ✓ Automatic Lubrication System
- ✓ Coolant System
- ✓ Led Working Lamp
- ✓ End Of Program Light
- ✓ Electronic Handwheel (Mpg)
- ✓ Tool Box
- ✓ Leveling Bolts and Blocks
- ✓ Coolant Gun
- ✓ Air Gun
- ✓ 2 Screw Type and 1 Chain Type Chip Conveyor
- ✓ Chip Flushing System
- ✓ User Manual

Optional configuration

- Belt Drive Spindle 6000rpm
- Gearbox Spindle 6000rpm
- Z Axis 720mm
- 4th or 4/5th Axis
- Workpiece Probe
- Tool Probe
- Oil Skimmer



Work table

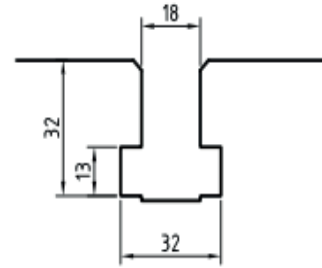
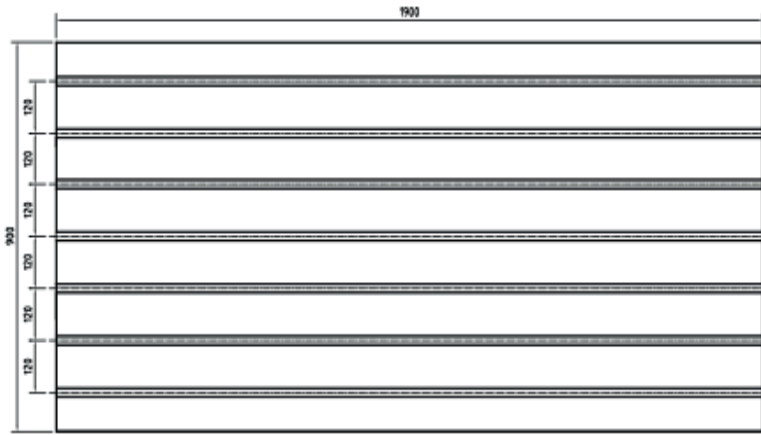

Dimensions

