

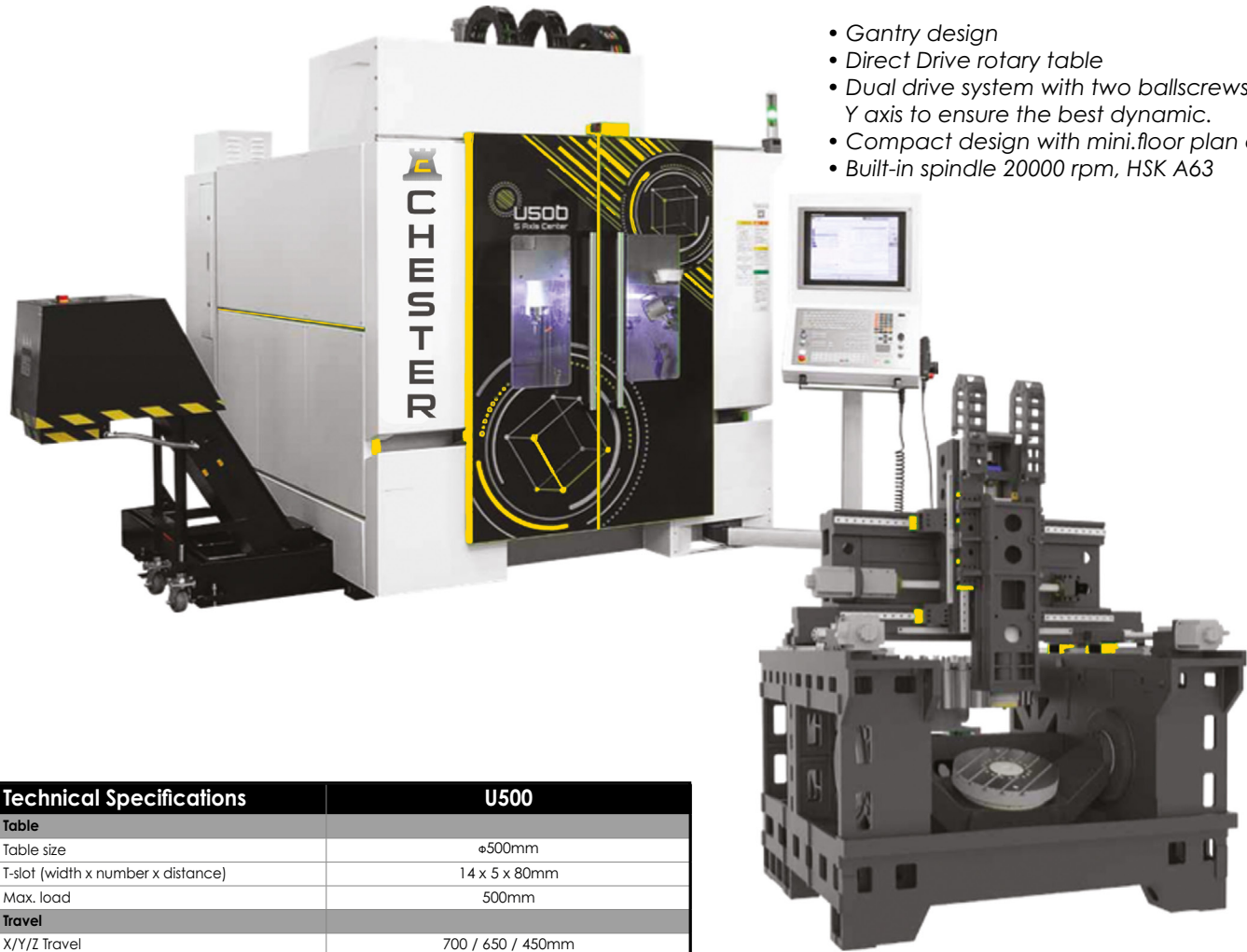

Chester 5 Axis Milling Machine • U500

Powerful High Speed Precision Machining

- Gantry design
- Direct Drive rotary table
- Dual drive system with two ballscrews on Y axis to ensure the best dynamic.
- Compact design with mini.floor plan area
- Built-in spindle 20000 rpm, HSK A63



Technical Specifications	U500
Table	
Table size	ø500mm
T-slot (width x number x distance)	14 x 5 x 80mm
Max. load	500mm
Travel	
X/Y/Z Travel	700 / 650 / 450mm
A/C Travel	+30° ~ -110° / 360°
Spindle nose to table	120 - 570mm
Spindle	
Spindle taper	HSK A63
Spindle motor power	20 / 24 kW
Spindle motor torque	35/42 Nm
Spindle speed	20000 rpm
Feed	
Rapid feed X/Y/Z	36 m/min
Rotation speed A/C	100 / 170 rpm
Cutting speed	1-12000 mm/min
Tool changer	
Number of tools	40 pcs
Max. tool length	250mm
Max. tool weight	4kg
Accuracy (VDI 3441)	
Positioning accuracy (with linear encoder)	0.006mm / Full Travel
Repeatability accuracy (with linear encoder)	0.003mm / Full Travel
Positioning/Repeatability accuracy (A axis)	5/2.5 arcsec
Positioning/Repeatability accuracy (C axis)	3/2 arcsec
Dimensions & Weight	
Dimensions	3586 x 2803 x 3030mm
Weight	9000kg

Standard Accessories:

- ✓ Full enclosed splash guard
- ✓ Motor spindle HSK A63 20000 rpm
- ✓ 40 pockets umbrella tool changer
- ✓ Chain type chip conveyor
- ✓ Air-conditioned electrical cabinet
- ✓ High precision spindle watercooler
- ✓ Linear scales
- ✓ Rigid tapping
- ✓ Ethernet ,CF card and USB interface
- ✓ Automatic lubrication system
- ✓ Coolant system
- ✓ Air blast during cutting
- ✓ LED working lamp
- ✓ End of program light
- ✓ Electronic handwheel(MPG)
- ✓ Tool box
- ✓ Leveling bolts and blocks
- ✓ Coolant gun
- ✓ Air gun
- ✓ User Manual

Optional Accessories:

- Built-in motor spindle HSK A63 18000rpm
- Built-in motor spindle HSK E50 36000rpm air-oil lubrication
- CTS Coolant through spindle + ATS
- Oil cooled ballscrew
- Oil skimmer
- Workpiece probe
- Tool probe
- Dynamic Collision Monitoring(DCM)
- Kinematics

* The above specifications are subject to change without prior notice, no liability for mistakes. Machines may be shown with optional equipment.





Torque diagram for standard Siemens version

U500 · 20000 rpm · HSK A63

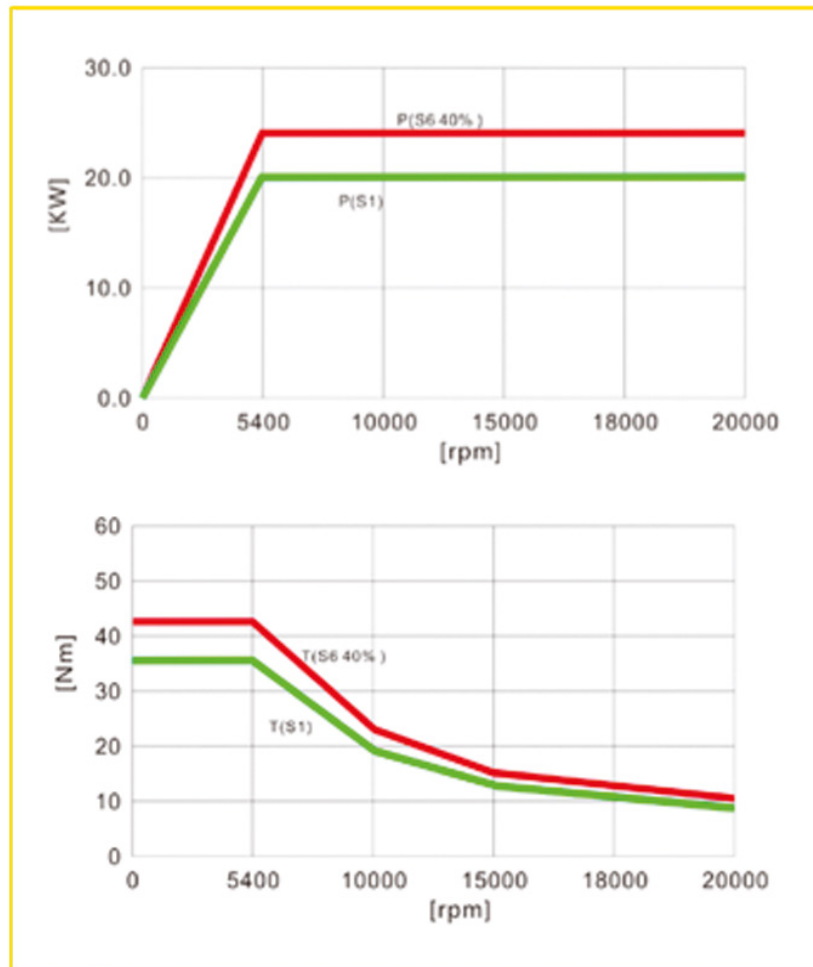

* The above specifications are subject to change without prior notice, no liability for mistakes. Machines may be shown with optional equipment.





Cutting Area and Interference Area

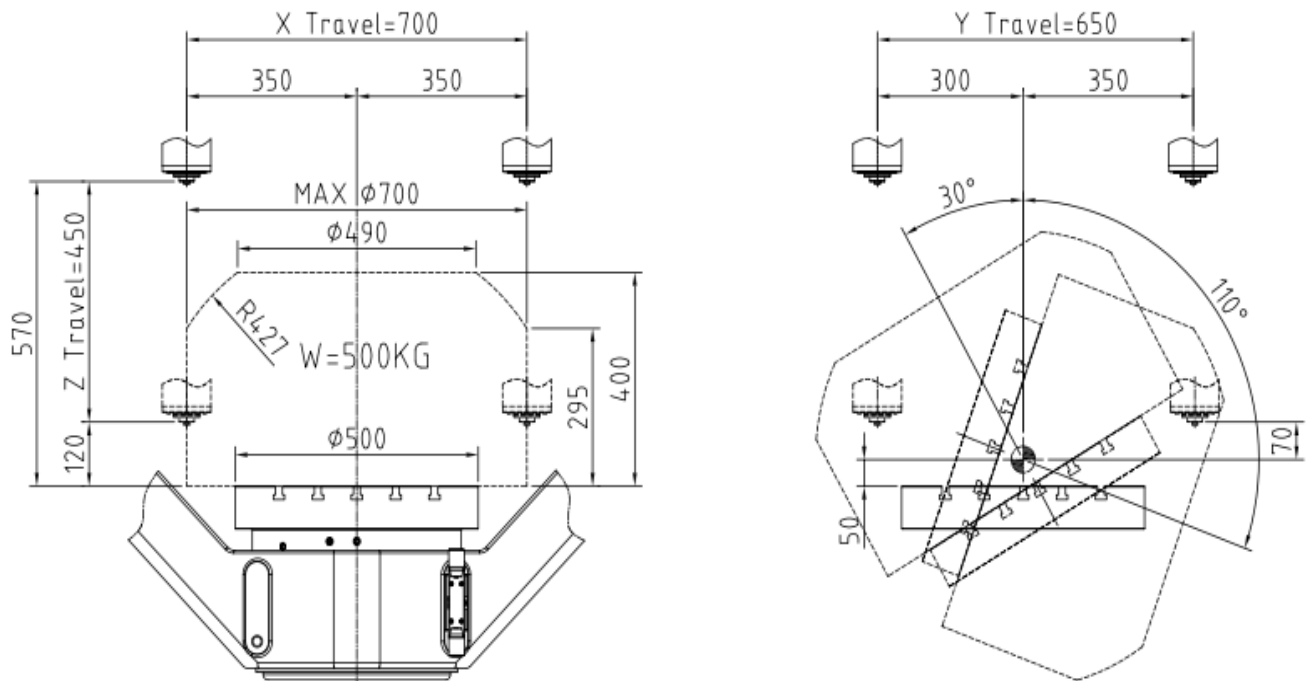

Dimensions

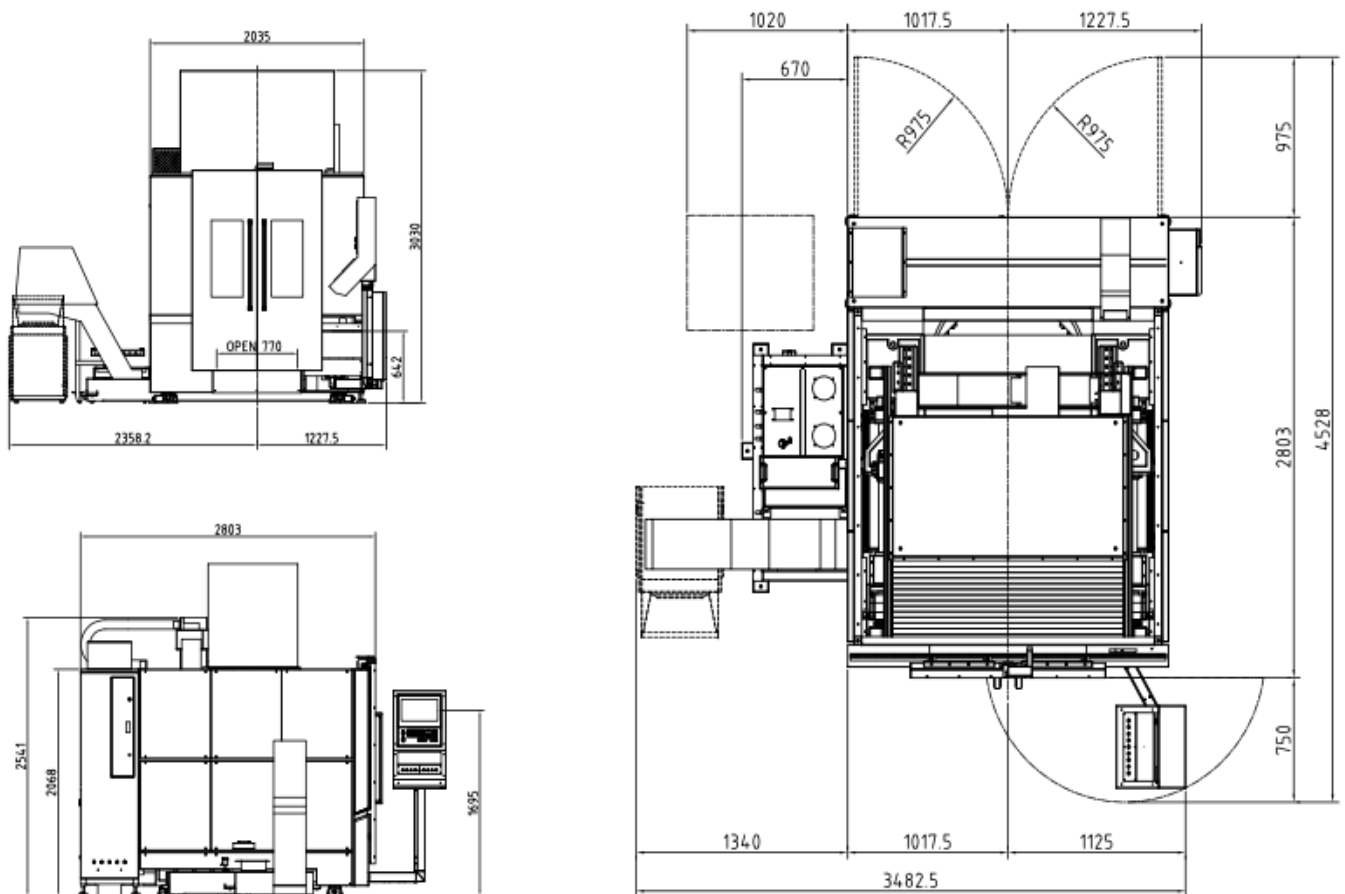

* The above specifications are subject to change without prior notice, no liability for mistakes. Machines may be shown with optional equipment.

